

PRODUCT CODES AND TECHNICAL FEATURES

> R401TG



Angle valve with thermostatic option, with iron pipe connection.
 Fluid of use: water and glycol solutions (max. 30 %)
 Temperature range: 5÷110 °C
 Max. working pressure: 16 bar with manual handwheel; 10 bar in combination with thermostatic heads
 Max. differential pressure with thermostatic heads: 0,7 bar (3/4"); 0,4 bar (1")

Materials

Body and main components: UNI EN 12165 CW617N brass
 Monobloc command stem: stainless steel
 Worksite protection handwheel: PP-H
 Gaskets: EPDM

Product code	Connections	Finishing	Type of knob	Type of tail piece
R401X034	3/4" M (G, ISO 228) x 3/4" F (G, ISO 228)	Chrome plated brass	Worksite protection	Tail piece without self-sealing
R401X035	1" M (G, ISO 228) x 1" F (G, ISO 228)	Chrome plated brass	Worksite protection	Tail piece without self-sealing

Product code	G x B	H [mm]	I [mm]	J [mm]	K [mm]	L [mm]	M [mm]	W [mm]
R401X034	3/4" x 3/4"	60	60	25	32	78	23	38
R401X035	1" x 1"	78	72	31	39	94	23	46

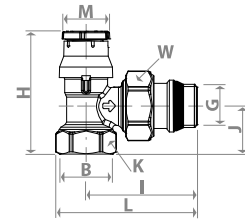

Hydraulic features

R401X034

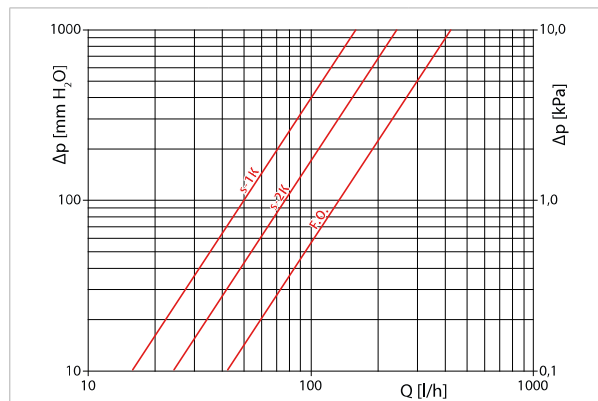

With R460, R468, R468C, R470, R462, R463 thermostatic heads

s-1K	s-2K	F.O.
0,50	0,76	1,41

R401X035

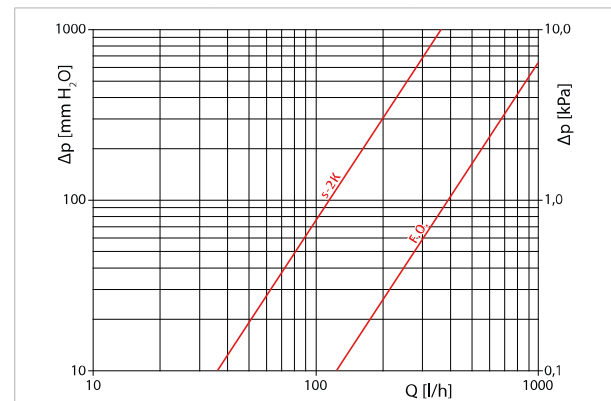

With R460, R468, R468C, R470, R462, R463 thermostatic heads

s-1K	s-2K	F.O.
-	1,22	3,98