

MANUAL HANDWHEEL

The habit, still strongly diffused, of installing manual valves has led Giacomini to include this type of valves within the "Giacotech" TG, F series.

The "Giacotech" TG, F series manual valves are characterized, as well as by simple maneuverability, by a new and more comfortable operating knob equipped with a specific worksite protection.



PRODUCT CODES AND TECHNICAL FEATURES

> R25TG



Angle manual valve, with connection for copper, plastic or multilayer pipe adaptor.

Fluid of use: water and glycol solutions (max. 30 %)

Temperature range: 5÷110 °C

Max. working pressure: 16 bar

Materials

Body and main components: UNI EN 12165 CW617N brass

Monobloc command stem: UNI EN 12164 CW617N brass

Manual handwheel: ABS

Gaskets: EPDM

Product code	Connections	Finishing	Type of knob	Adaptors to use	Type of tail piece
R25X032	3/8" M (G, ISO 228) x base 16	Chrome plated brass	Manual handwheel	R178, R178C, R179, R179AM	Tail piece with self-sealing
R25X033	1/2" M (G, ISO 228) x base 16	Chrome plated brass	Manual handwheel	R178, R178C, R179, R179AM	Tail piece with self-sealing
R25X034	1/2" M (G, ISO 228) x base 18	Chrome plated brass	Manual handwheel	R178, R178C, R179, R179AM	Tail piece with self-sealing
R25X035	3/4" M (G, ISO 228) x base 18	Chrome plated brass	Manual handwheel	R178, R178C, R179, R179AM	Tail piece without self-sealing
R25X036	3/4" M (G, ISO 228) x base 22	Chrome plated brass	Manual handwheel	R178, R178C, R179, R179AM	Tail piece without self-sealing

Product code	G x B	H [mm]	I [mm]	J [mm]	L [mm]	M [mm]	W [mm]
R25X032	3/8" x 16	69	53	21	74	42	30
R25X033	1/2" x 16	69	53	21	74	42	30
R25X034	1/2" x 18	73	54	24	75	42	30
R25X035	3/4" x 18	79	60	24	84	49	38
R25X036	3/4" x 22	79	60	24	84	49	38

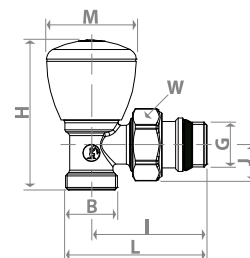

Hydraulic features

R25X032, R25X033, R25X034, R25X035, R25X036

Kv obtained with Giacomini laboratory loss of pressure station

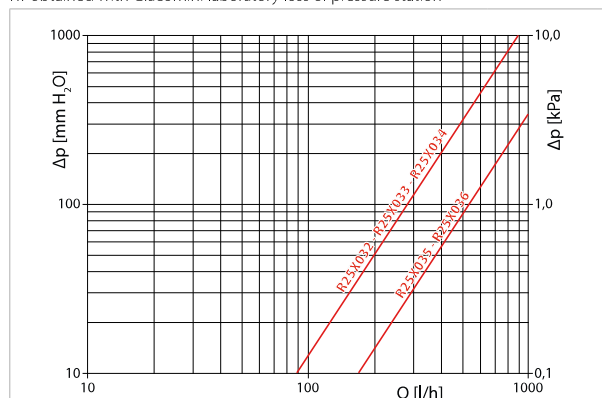

Handwheel position Fully Open

R25X032	R25X033	R25X034	R25X035	R25X036
2,88	2,88	2,88	5,34	5,34