

> R5TG



Angle manual valve, with iron pipe connection.
 Fluid of use: water and glycol solutions (max. 30 %)
 Temperature range: 5 ÷ 110 °C
 Max. working pressure: 16 bar

Materials
 Body and main components: UNI EN 12165 CW617N brass
 Monobloc command stem: UNI EN 12164 CW617N brass
 Manual handwheel: ABS
 Gaskets: EPDM

Product code	Connections	Finishing	Type of knob	Type of tail piece
R5X032	3/8"M (G, ISO 228) x 3/8"F (G, ISO 228)	Chrome plated brass	Manual handwheel	Tail piece with self-sealing
R5X033	1/2"M (G, ISO 228) x 1/2"F (G, ISO 228)	Chrome plated brass	Manual handwheel	Tail piece with self-sealing
R5X034	3/4"M (G, ISO 228) x 3/4"F (G, ISO 228)	Chrome plated brass	Manual handwheel	Tail piece without self-sealing
R5X035	1"M (G, ISO 228) x 1"F (G, ISO 228)	Chrome plated brass	Manual handwheel	Tail piece without self-sealing
R5X036	1 1/4"M (G, ISO 228) x 1 1/4"F (G, ISO 228)	Chrome plated brass	Manual handwheel	Tail piece without self-sealing

Product code	G x B	H [mm]	I [mm]	J [mm]	K [mm]	L [mm]	M [mm]	W [mm]
R5X032	3/8" x 3/8"	65	50	19	22	71	42	27
R5X033	1/2" x 1/2"	70	53	21	26	74	42	30
R5X034	3/4" x 3/4"	79	60	23	32	84	49	38
R5X035	1" x 1"	87	68	30	39	92	49	46
R5X036	1 1/4" x 1 1/4"	93	81	34	49	110	59	53

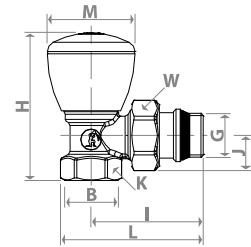

Hydraulic features

R5X032, R5X033, R5X034, R5X035, R5X036

Kv obtained with Giacomini laboratory loss of pressure station

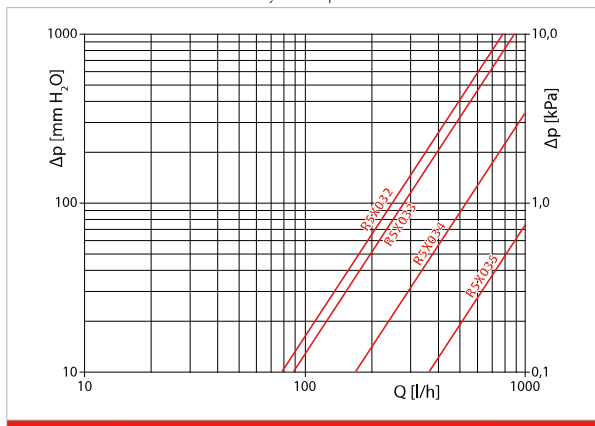

Handwheel position Fully Open

R5X032	R5X033	R5X034	R5X035	R5X036
2,46	2,88	5,34	11,50	-